

1

2

3

# Dialogue of the Carmelites



Venue	Corbett Auditorium
Director	Robin Guarino
Sound Designer	Alena Milos
Asst Sound Designer	Lucia Thill
PSE	Michael Donahue

## NOTES:

## Groundplan: Stage and Pit

V3

Drafted By  
Alena Milos

Contact Info  
milosaa@mail.uc.edu  
(440) 409-6375

Last Revised  
10/28/22

Scale:  
1:1

Sheet:  
**1**  
OF  
**3**

1

2

3

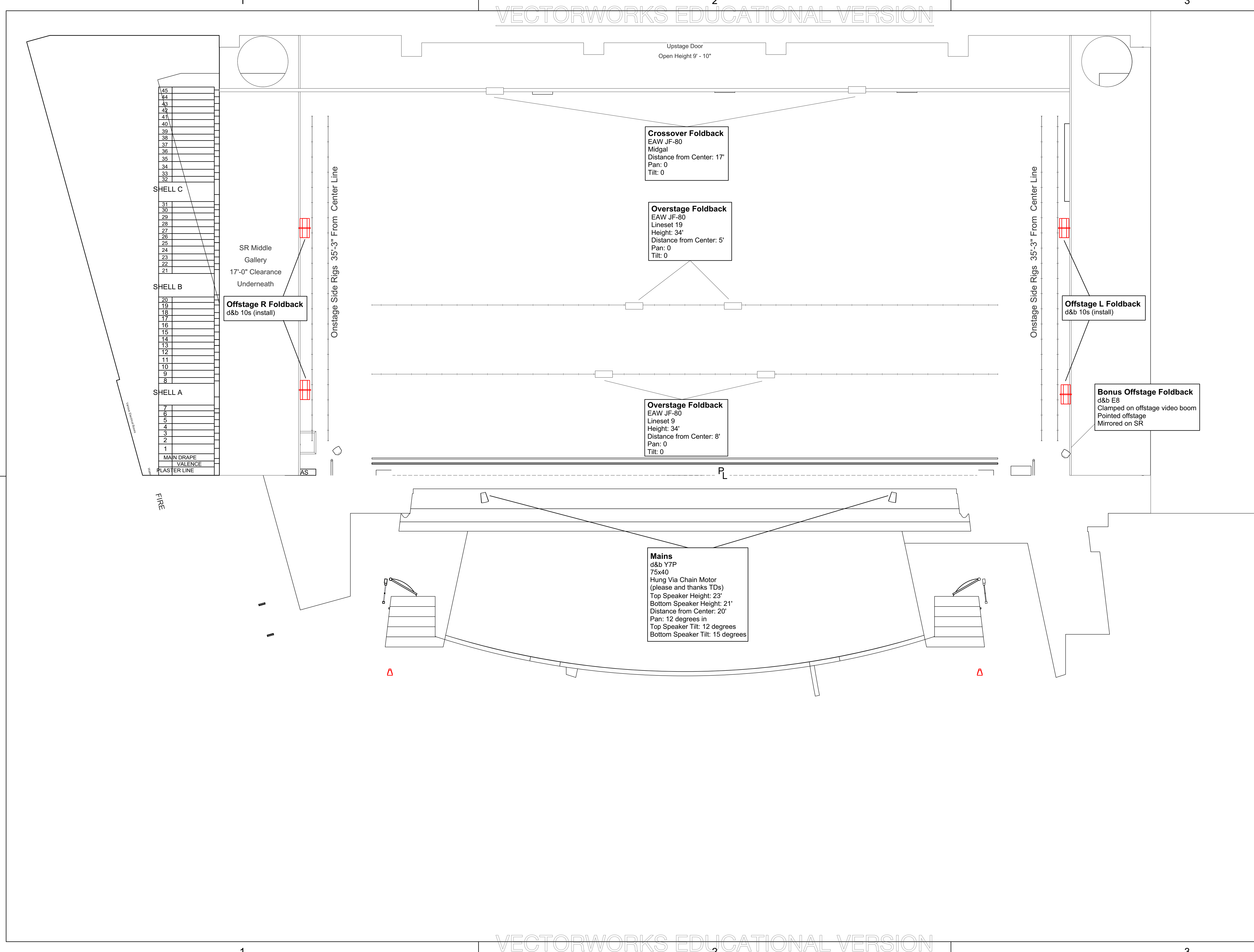

**Crossover Foldback**  
EAW JF-80  
Midgal  
Distance from Center: 17'  
Pan: 0  
Tilt: 0

**Overstage Foldback**  
EAW JF-80  
Lineset 19  
Height: 34'  
Distance from Center: 5'  
Pan: 0  
Tilt: 0

**Overstage Foldback**  
EAW JF-80  
Lineset 9  
Height: 34'  
Distance from Center: 8'  
Pan: 0  
Tilt: 0

**Offstage L Foldback**  
d&b 10s (install)

**Bonus Offstage Foldback**  
d&b E8  
Clamped on offstage video boom  
Pointed offstage  
Mirrored on SR

**Mains**  
d&b Y7P  
75x40  
Hung Via Chain Motor  
(please and thanks TDs)  
Top Speaker Height: 23'  
Bottom Speaker Height: 21'  
Distance from Center: 20'  
Pan: 12 degrees in  
Top Speaker Tilt: 12 degrees  
Bottom Speaker Tilt: 15 degrees

**Offstage R Foldback**  
d&b 10s (install)

SR Middle  
Gallery  
17'-0" Clearance  
Underneath

- 45
- 44
- 43
- 42
- 41
- 40
- 39
- 38
- 37
- 36
- 35
- 34
- 33
- 32
- 31
- 30
- 29
- 28
- 27
- 26
- 25
- 24
- 23
- 22
- 21
- 20
- 19
- 18
- 17
- 16
- 15
- 14
- 13
- 12
- 11
- 10
- 9
- 8
- 7
- 6
- 5
- 4
- 3
- 2
- 1
- MAIN DRAPE
- VALENCE
- PLASTER LINE

Onstage Side Rigs 35'-3" From Center Line

Onstage Side Rigs 35'-3" From Center Line

FIRE

Upstage Door  
Open Height 9' - 10"

# Dialogue of the Carmelites



Venue  
Corbett Auditorium

Director  
Robin Guarino

Sound Designer  
Alena Milos

Asst/Assoc Sound Designer  
Lucia Thill

PSE  
Michael Donahue

## NOTES:

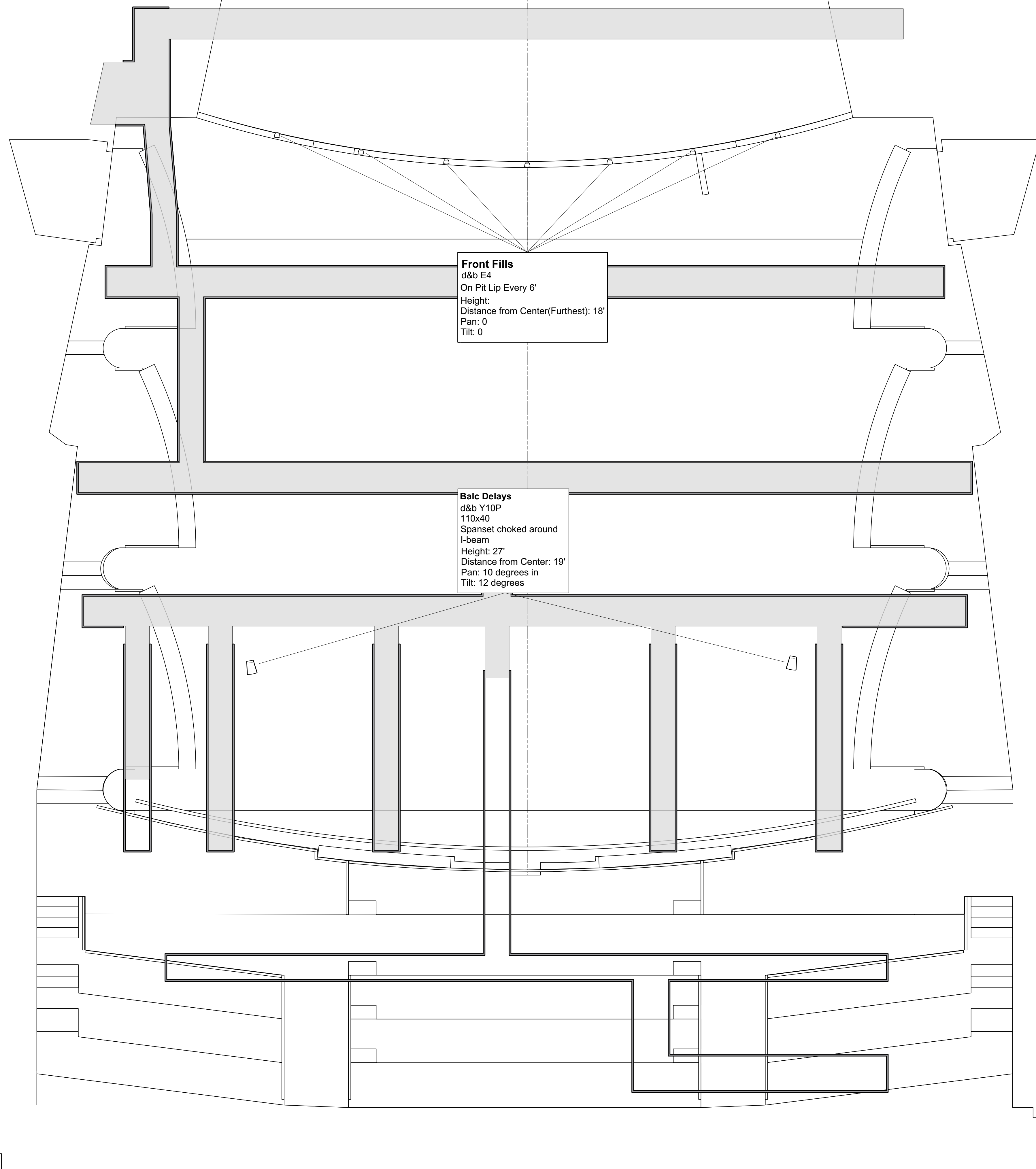

**Front Fills**  
d&b E4  
On Pit Lip Every 6'  
Height:  
Distance from Center(Furthest): 18'  
Pan: 0  
Tilt: 0

**Balc Delays**  
d&b Y10P  
110x40  
Spanset choked around  
I-beam  
Height: 27'  
Distance from Center: 19'  
Pan: 10 degrees in  
Tilt: 12 degrees

## Groundplan: House

V3

Drafted By  
Alena Milos

Contact Info  
milosaa@mail.uc.edu  
(440) 409-6375

Last Revised

10/28/22

Scale:

1:1

Sheet:

2  
OF  
3

# Dialogue of the Carmelites



Venue	Corbett Auditorium
Director	Robin Guarino
Sound Designer	Alena Milos
Asst/Assoc Sound Designer	Lucia Thill
PSE	Michael Donahue

## NOTES:

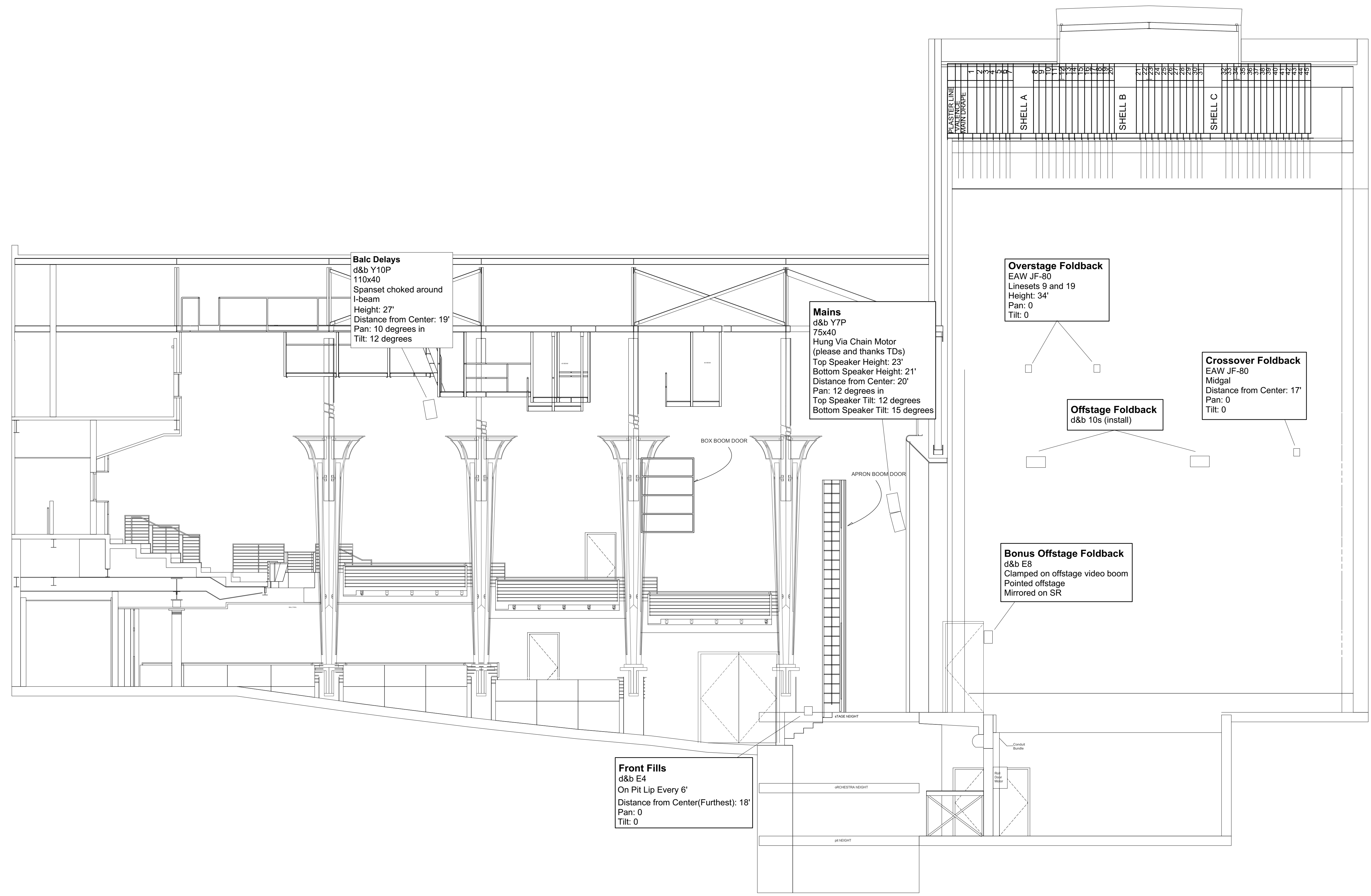

## Section View V3

Drafted By Alena Milos

Contact Info milosaa@mail.uc.edu (440) 409-6375

Last Revised 10/28/22

Scale: 3/4:1

Sheet: 3 OF 3